

BRG are MAG  
DMN in M  
ELEV in FT

RWY	BRG MAG	COORD	VASIS	
			PAPI	MEHT
03	025°	THR 66 33 14.76 N 025 48 35.95 E	3.0°	56
21	205°	THR 66 34 31.96 N 025 51 03.07 E	3.0°	56

APN details, see EFRO AD 2.8  
TWY details, see EFRO AD 2.8 and AD 2.15  
RWY details, see EFRO AD 2.12  
ACFT stand details, see EFRO AD 2.20

VAR 11.9° E 2020  
Annual Change +0.2°

Closure LGT system  
Used only in low  
visibility conditions

PRECISION APPROACH  
CAT II LIGHTING SYSTEM

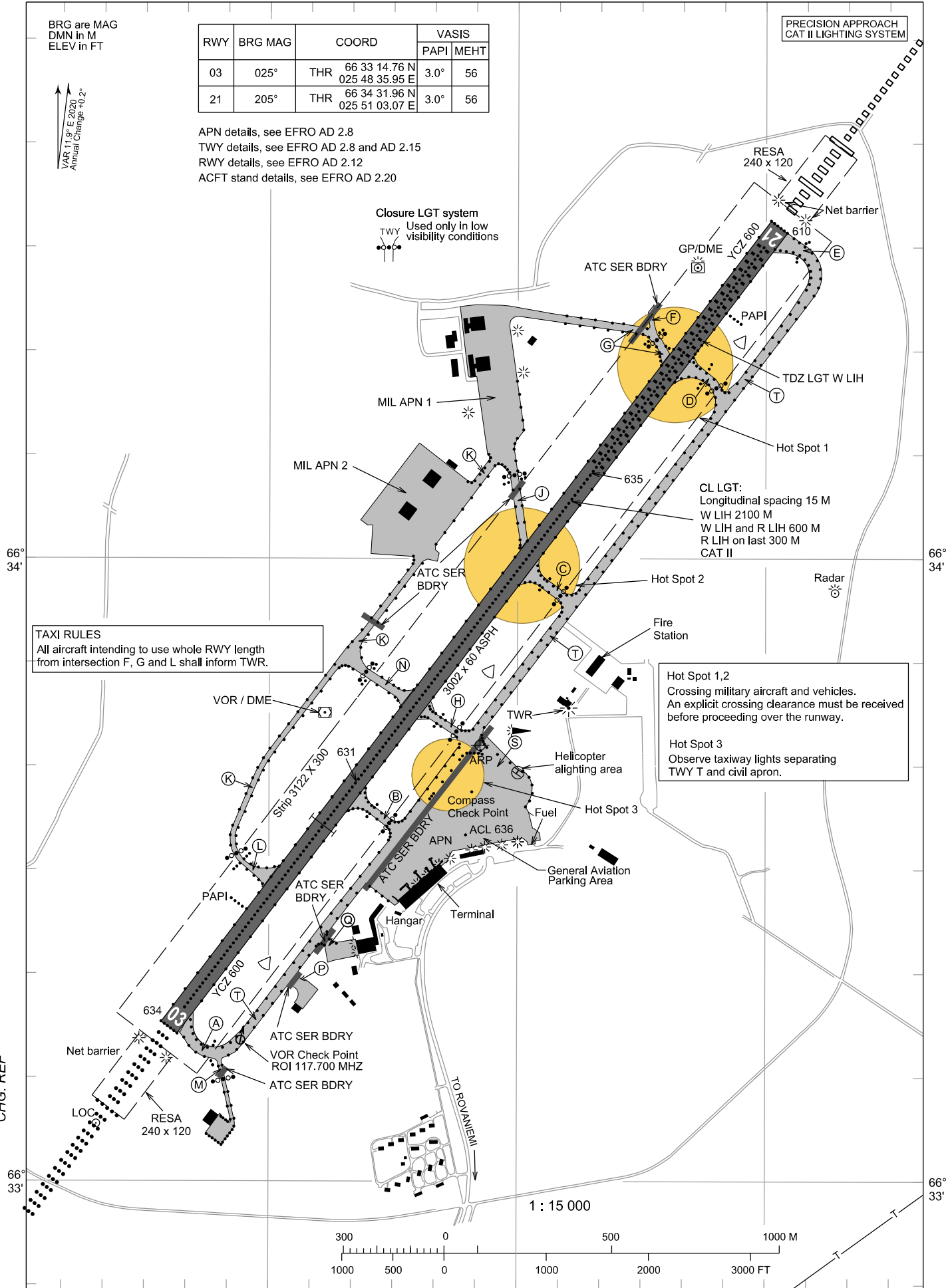

**TAXI RULES**  
All aircraft intending to use whole RWY length from intersection F, G and L shall inform TWR.

**Hot Spot 1,2**  
Crossing military aircraft and vehicles. An explicit crossing clearance must be received before proceeding over the runway.

**Hot Spot 3**  
Observe taxiway lights separating TWY T and civil apron.